

To Send Print Jobs to LPT:One Mobile Print from iDevice

1. Go to the App Store on the iDevice
2. Search for “PrinterOn” (all one word) and you will see these results

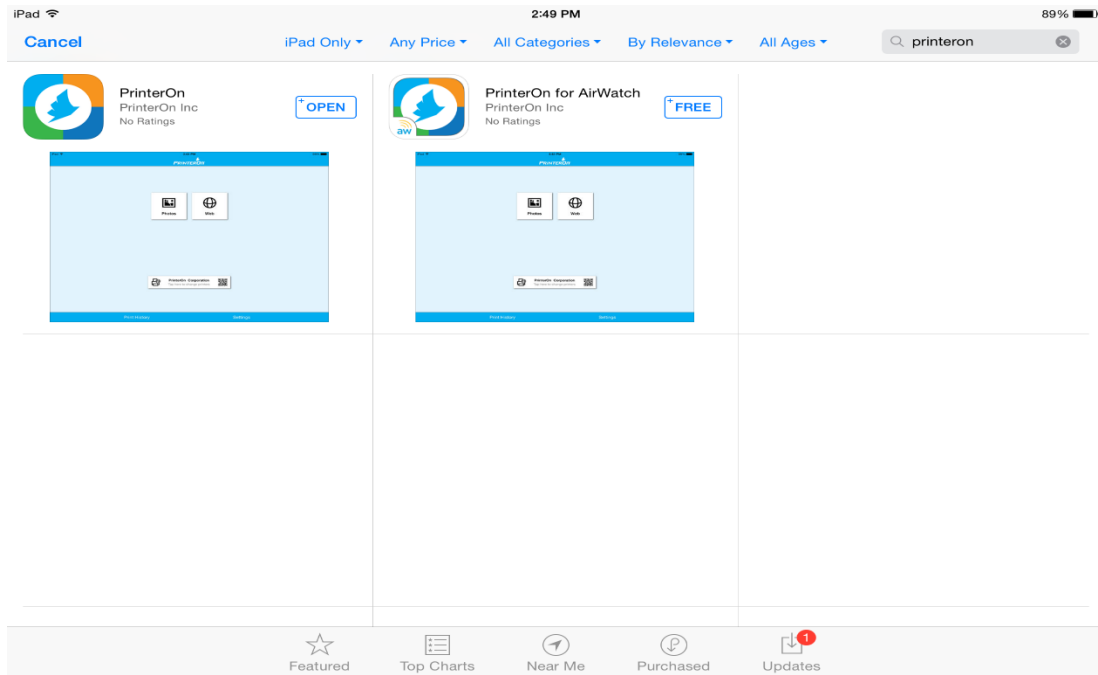

3. You want the app labeled simply “PrinterOn”, it is a free app
4. Once the app installs you will need to find it on the home screen and open it



- Once the app opens you will need to locate the printer, click on the box at the bottom of the screen (it will not have a printer selected the first time you open it)

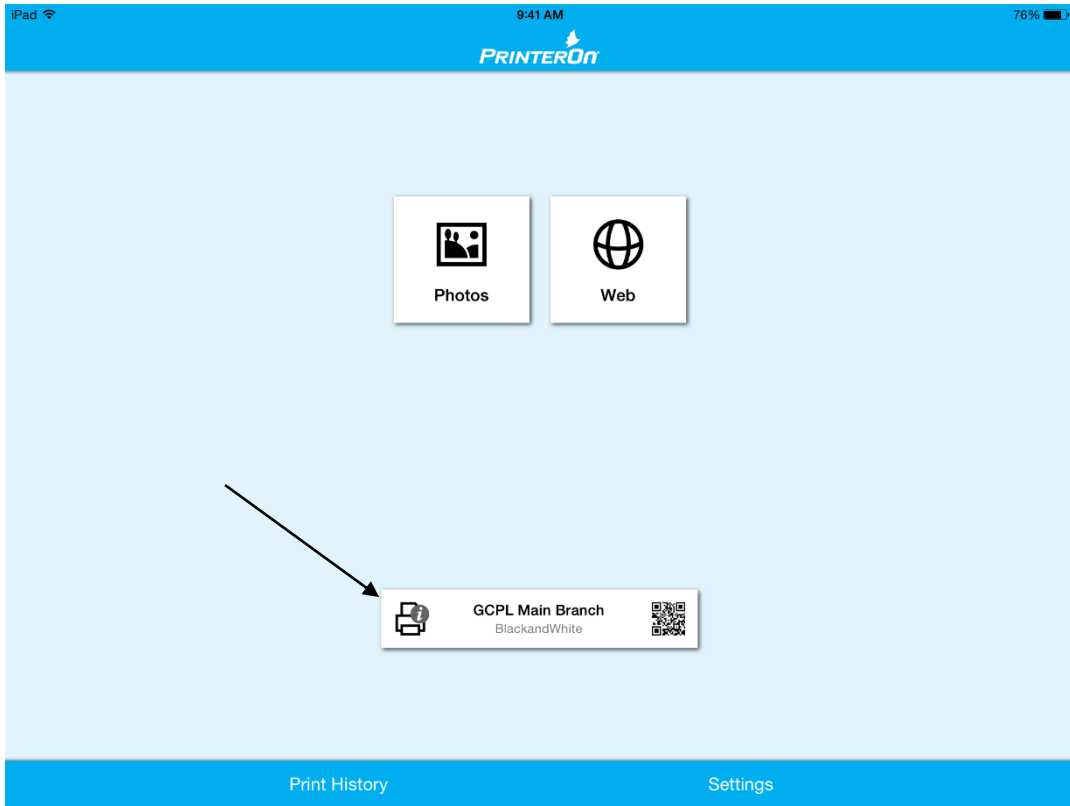

- In the new windows click on "Search" at the bottom of the screen

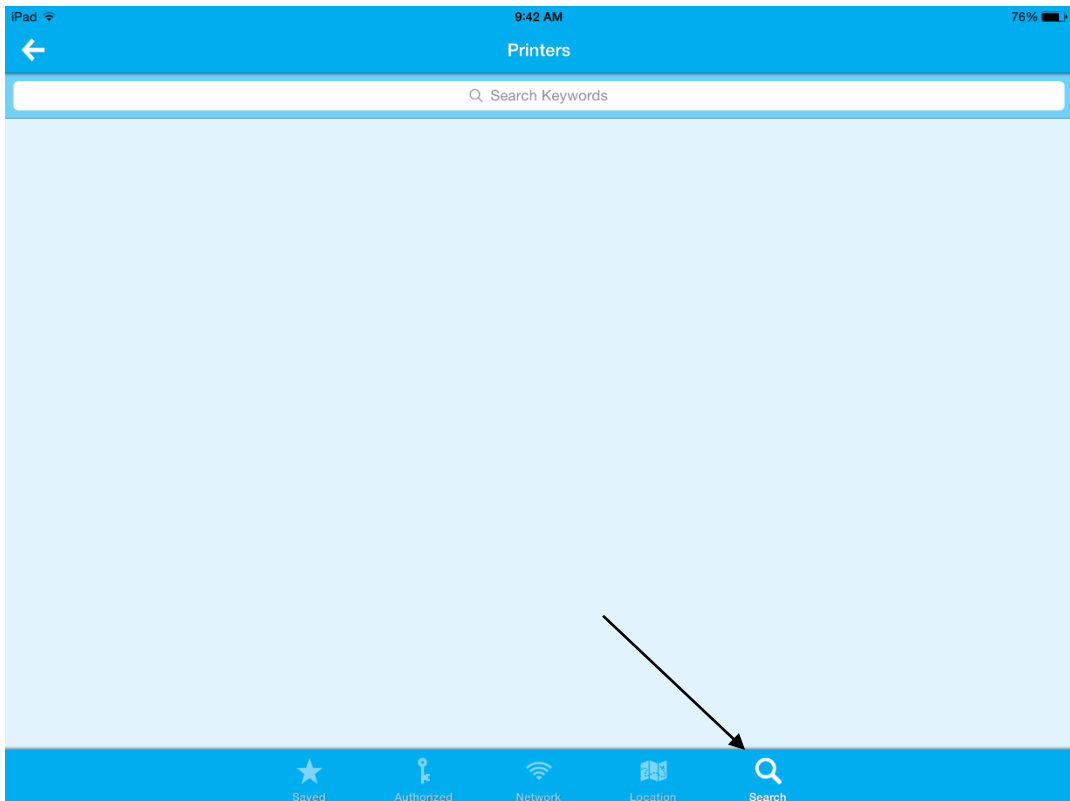

7. In the new window type “GCPL” in the search box and you will see the following results

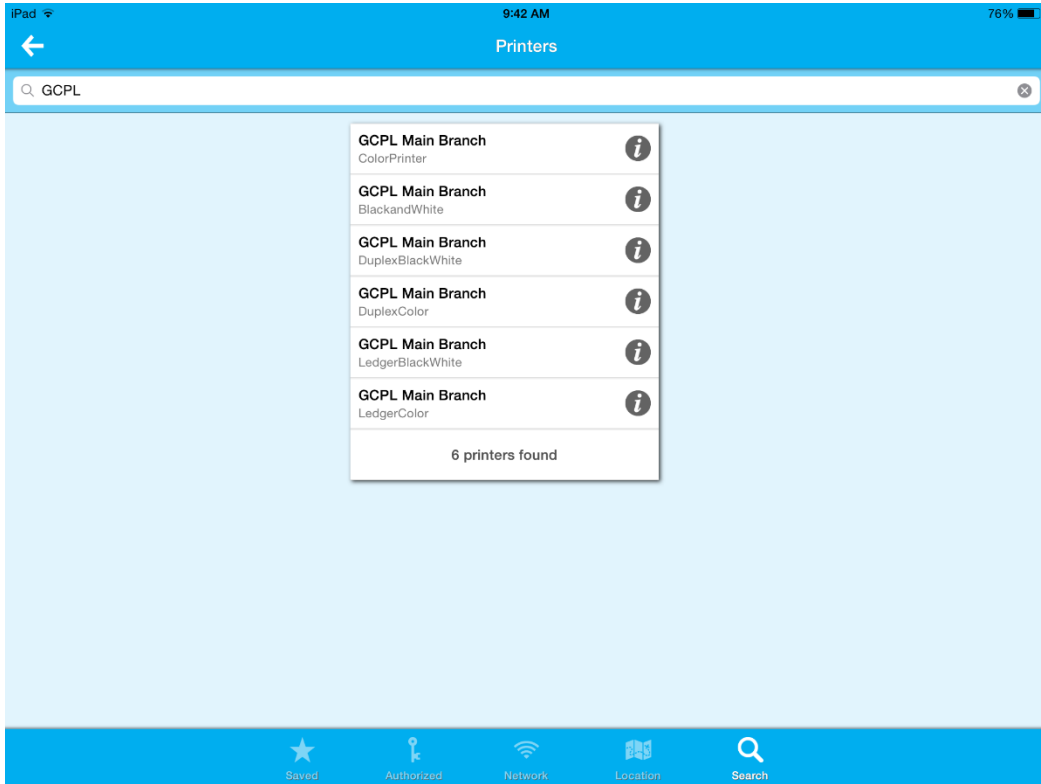

8. Click on the “i” within the circle for any printer

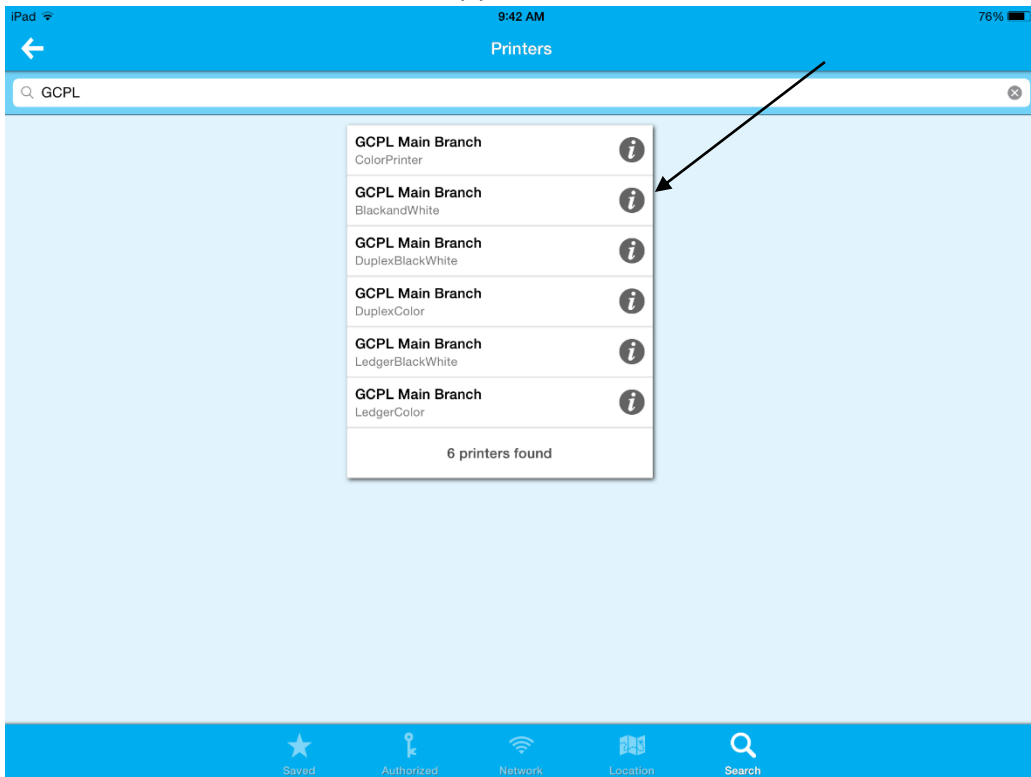

9. In the new screen click “Save Printer” so it will be saved to your device for future print jobs

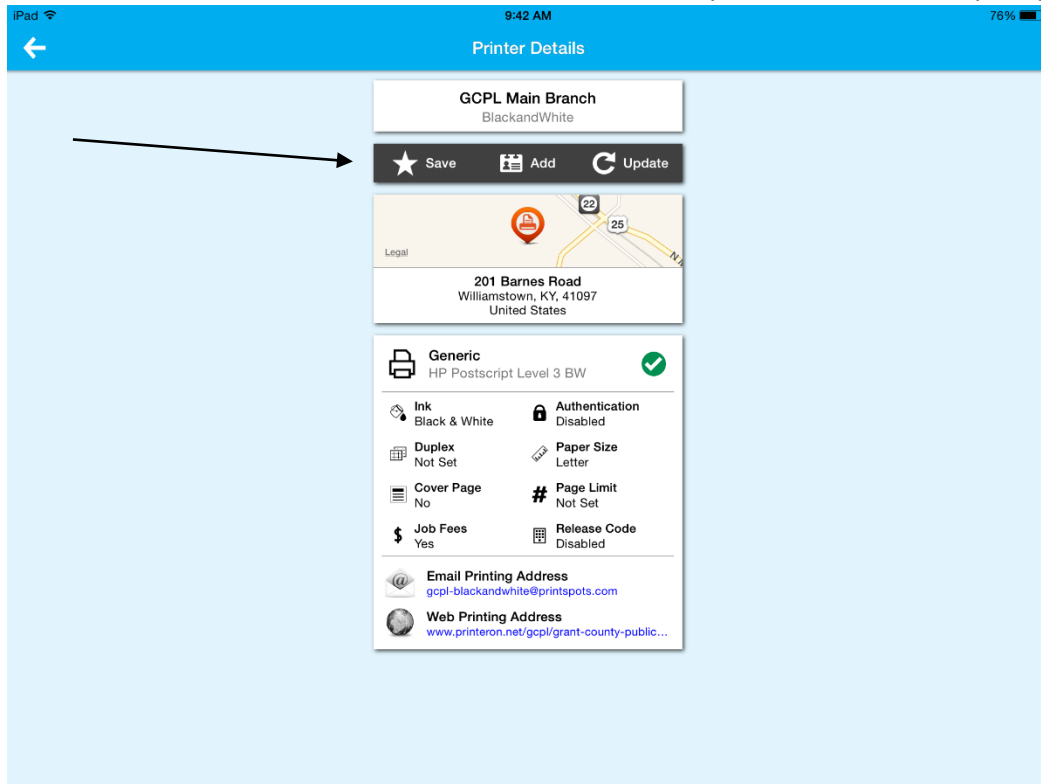

10. Repeat Steps 7 and 8 for any other printer if you would like to remember more than one
11. After saving the printers you can go back to the main screen to send a print job
12. If you want to change the printer you are printing to click on the bottom box and you will see a list of your saved printers

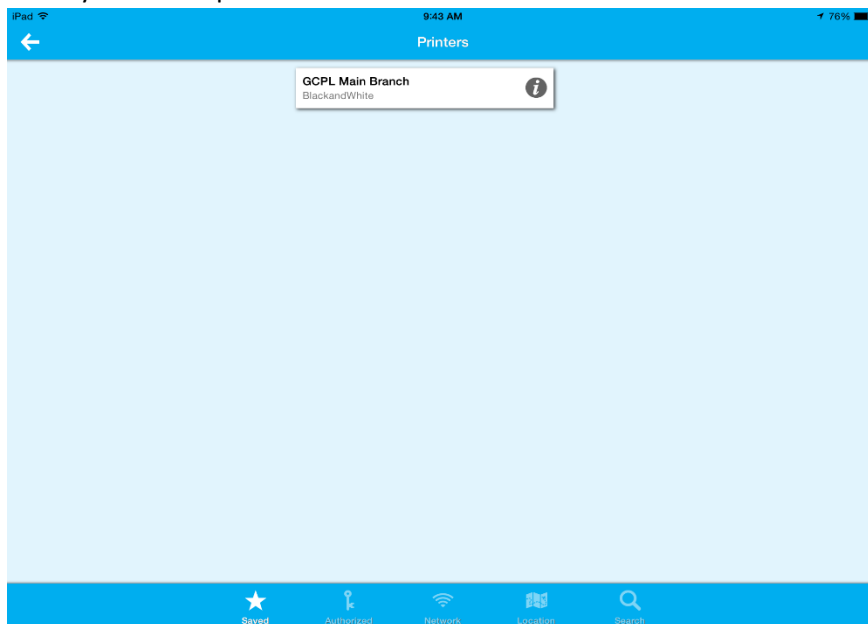

13. You can tap on the printer you wish to use

14. If you want to print a picture click on the "Photo" box

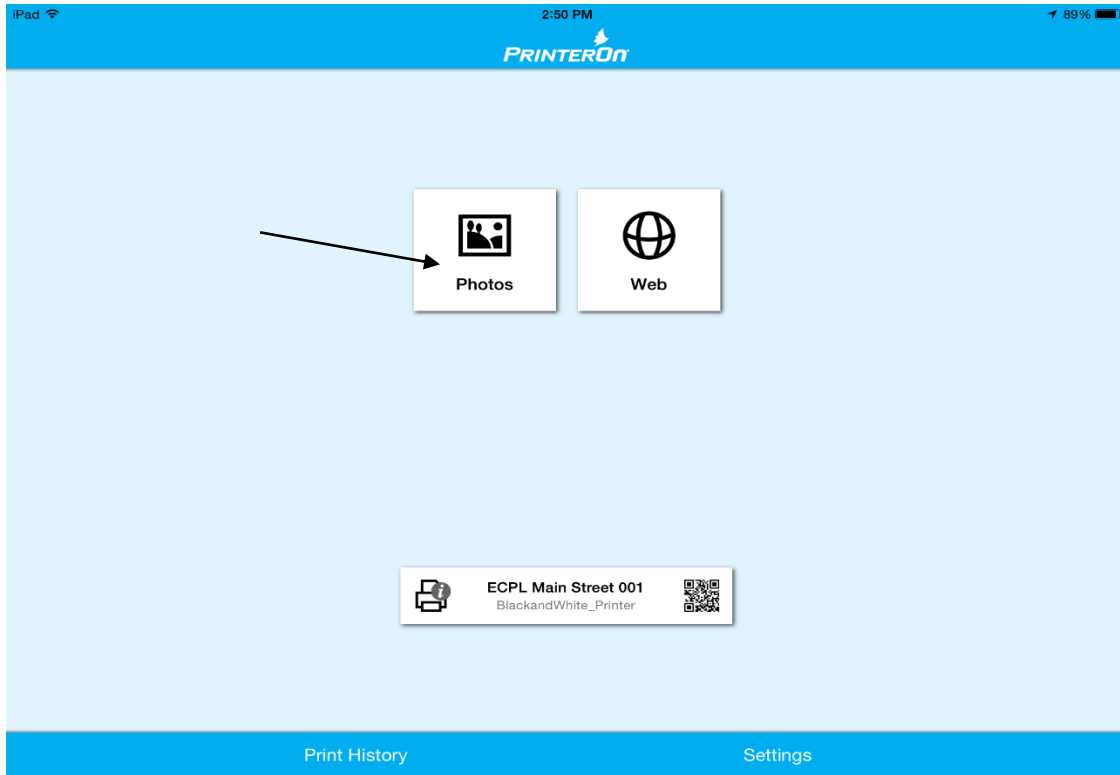

15. You will then be able to choose a picture saved on your iPad (Camera Roll)

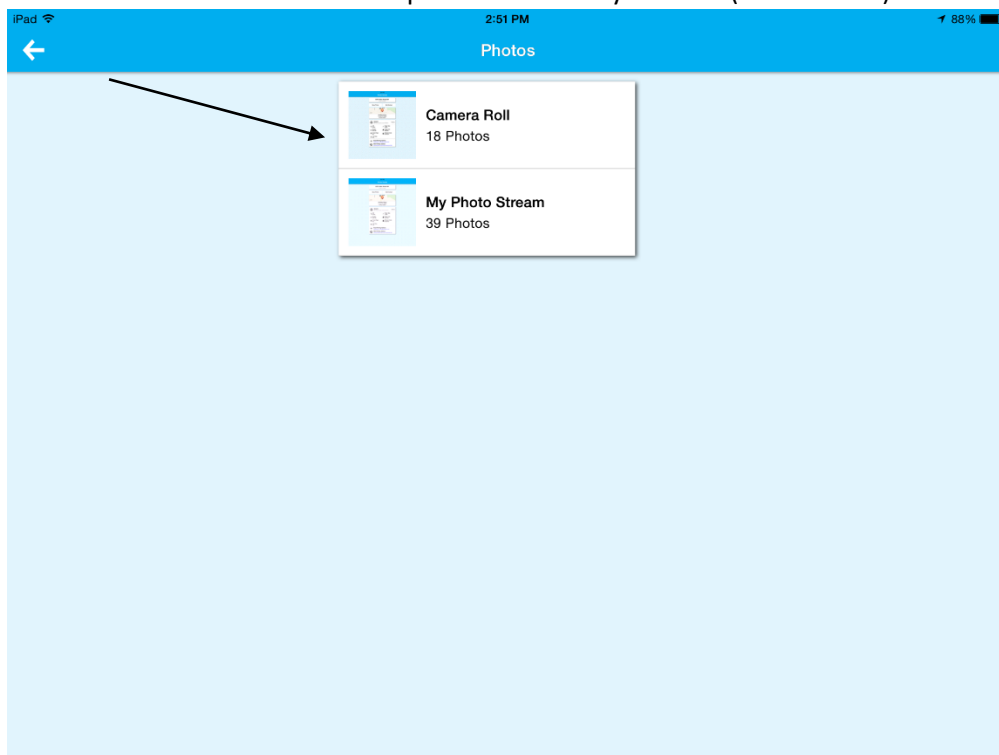

16. You can then select the picture you want to send to the library to print

17. If you want to print a web page select the “Web” box

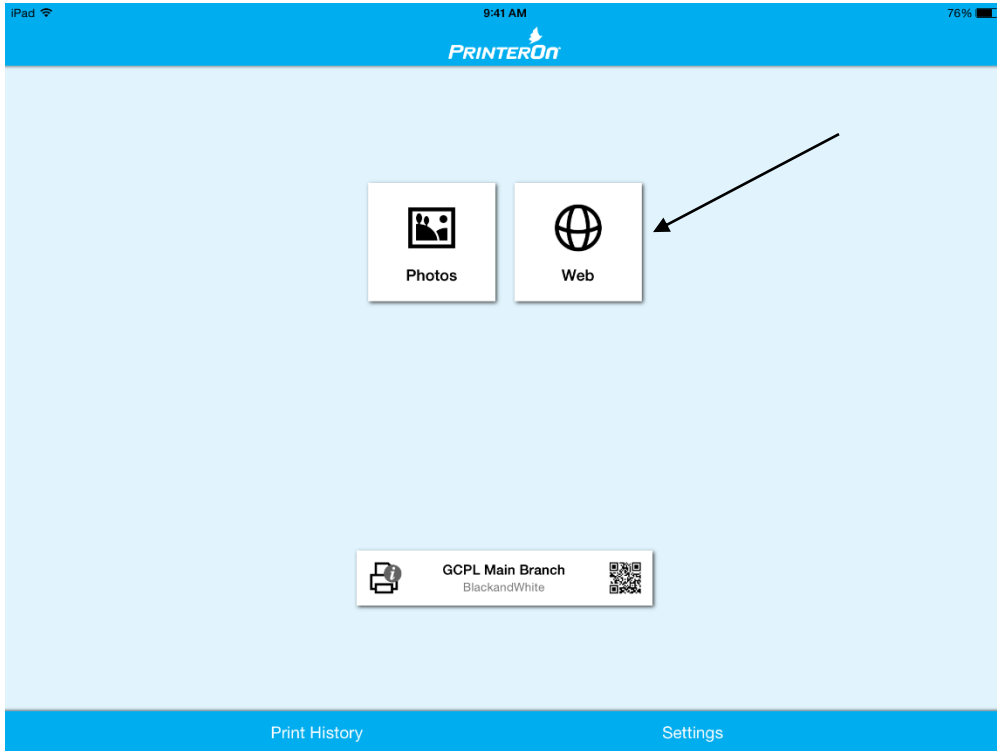

18. In the new page type in the URL you wish to print

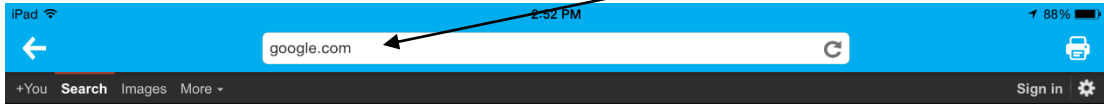

Google

Can you spell triskaidekaphobia? Try your hand at Spell Up.

Unknown - Use precise location



19. Once you are ready to print the job click on the printer icon in the top right corner



Google

Can you spell triskaidekaphobia? Try your hand at Spell Up.

Unknown - Use precise location



20. You will need to type in your email address on the next screen, after you have your email entered click on the checkmark in the top right corner

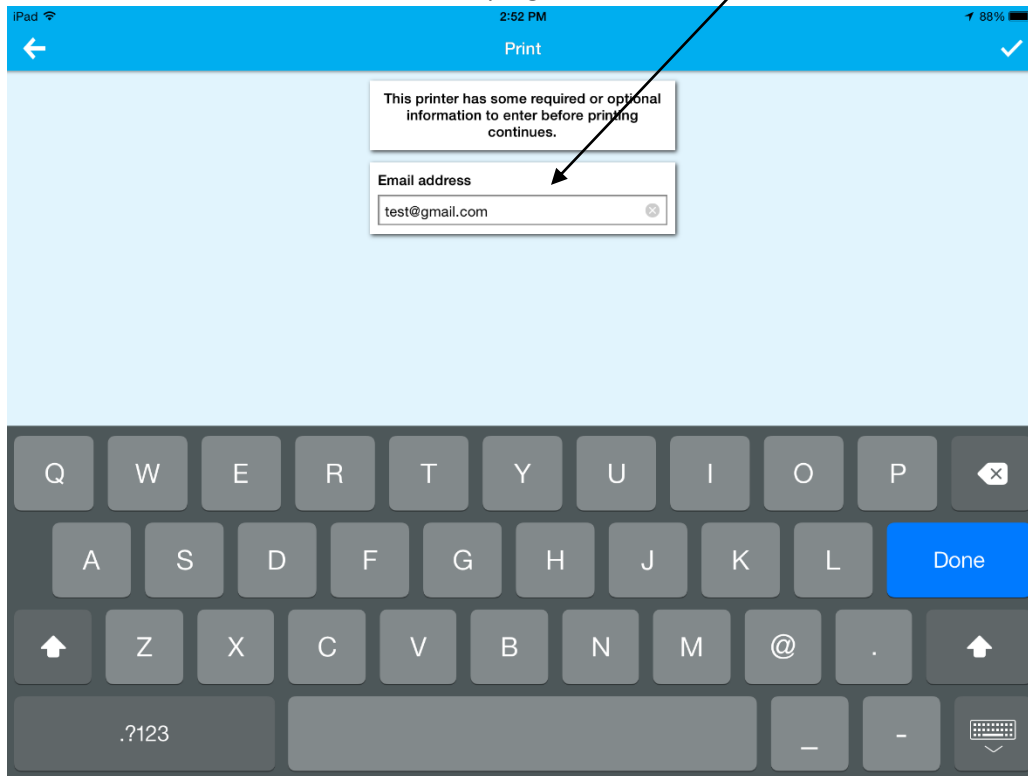

21. After this has completed you will be taken back to the main screen, you can check to see if it printed by viewing your "Print History" from the main screen

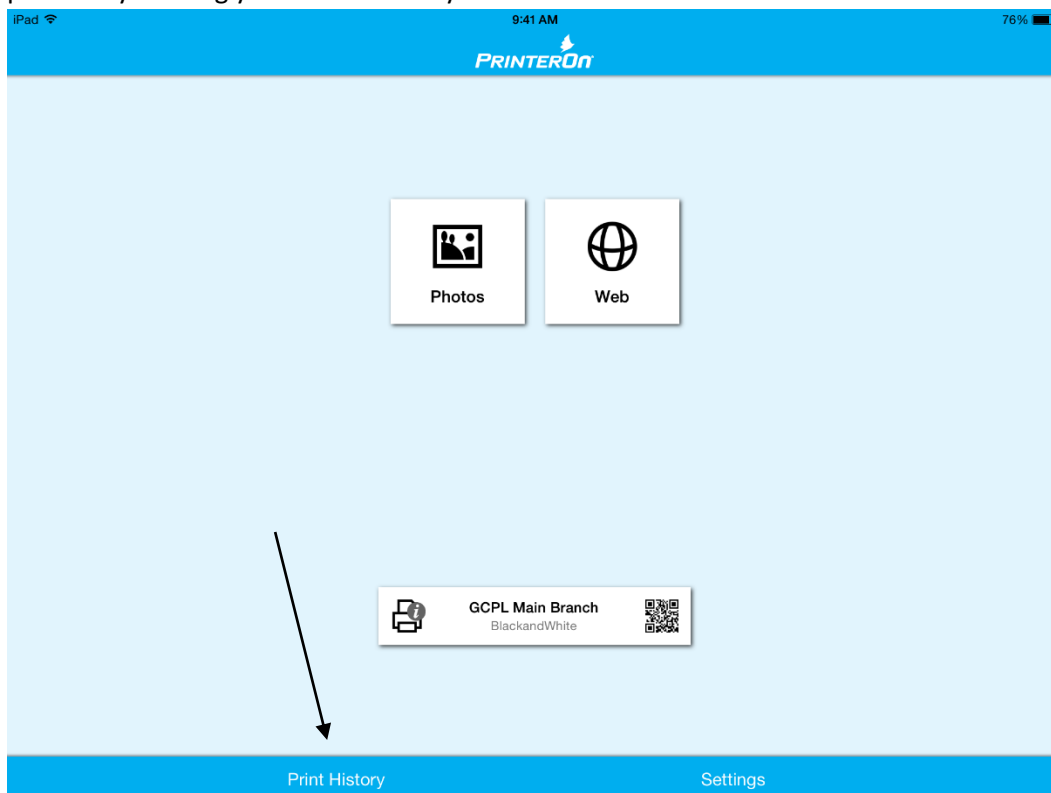

22. If it shows a “successful” print you can have it printed at the library

